



The robust, efficient and flexible design of the EuroCarrier makes it one of the best vessels for anchor handling, dredging support and survey activities. The EuroCarrier can be adapted to perfectly fit any project within a short time.

GENERAL	
IMO NR.	1117173
CALL SIGN	PCFU
YEAR BUILT	2026
HOME PORT	Aalst
CLASSIFICATION	Bureau Veritas I  HULL • MACH • AUT-UMS • DYNAPOS AM/AT, Unrestricted navigation, TUG Special Service / Multi Purpose Ship design, GMDSS Area A3,DPI

EuroCarrier 3013 | NP 640 DPI

DIMENSIONS		
LENGTH O.A.	30,15	meter
BREADTH MLD.	12,50	meter
DEPTH AT SIDE	3,40/3,97	meter
DRAFT	3,00	meter
DECK SPACE	125	m ²
GROSS TONNAGE	338	ton
NET TONNAGE	76	ton
PERFORMANCES		
SPEED	9	knots
BOLLARD PULL	40	ton
PROPULSION		
MAIN ENGINES	2x Caterpillar C32 ACERT, TIER 3	
TOTAL POWER	1940 kW at 1800 RPM	
PROPELLERS	1850 mm diameter in nozzle	
HYBRID PROPULSION	2 x 200 kW	
AUXILIARIES		
GENERATOR SETS	3x Volvo D13, 3x 500kW@1500 tpm	
	1x Volvo D7, 1x 116kW@1500 tpm	
TOTAL E-POWER	1616 kW	
STERNTHRUSTER	250 kW tunnel thruster aft engine room on centreline	
BOW THRUSTER	250 kW tunnel thruster in SB pushbow	

TANKS	
FUEL OIL	98,5 m ³
FRESH WATER	33,00 m ³
DECK LAY-OUT	
ANCHOR HANDLING WINCH	150 tons holding force
PULLING FORCE	100 tons at 1 st layer
HAULING SPEED	5m/min – 12,5m/min
TOWING WINCH	50 tons holding force
PULLING FORCE	50 tons at 1 st layer
HAULING SPEED	10m/min – 30m/min
TUGGER WINCH	15 tons at 1 st layer
DECK CRANE FORWARD	Heila HLRM 440-4S
DECK CRANE AFT	Heila HLRM 230-4SLK
DECK	Azobé deck covering
TOWING PINS	Aft ship; manual guide pins & gob eye flush in deck, fore ship: hydraulic guide pins & hydraulic chainstopper
FENDERING	Wood- and M-fendering on the side, pushbow fendering fore- and aft ship
ACCOMMODATION	
FACILITIES	Airconditioned accommodation 4 double and 3 single cabins.

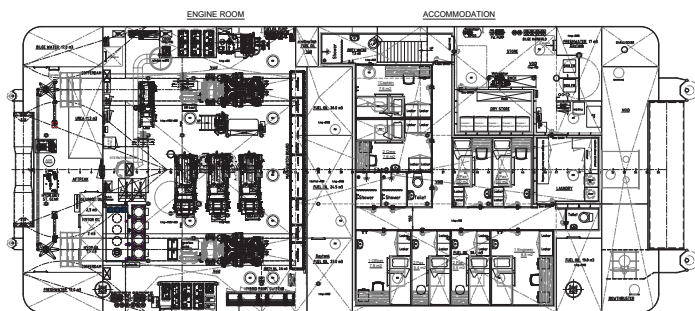
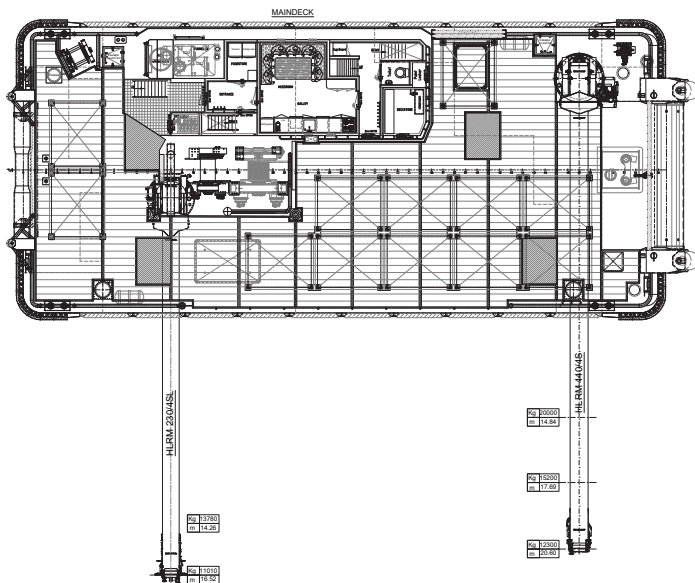
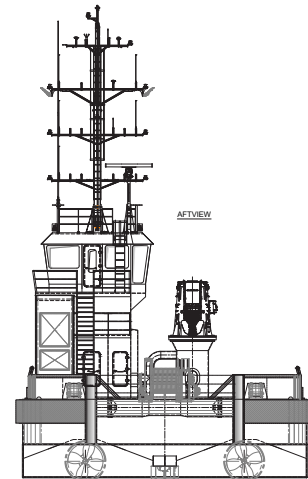
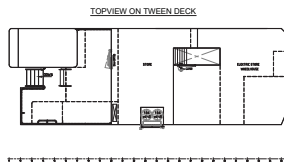
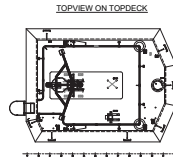
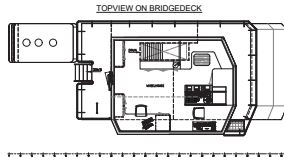
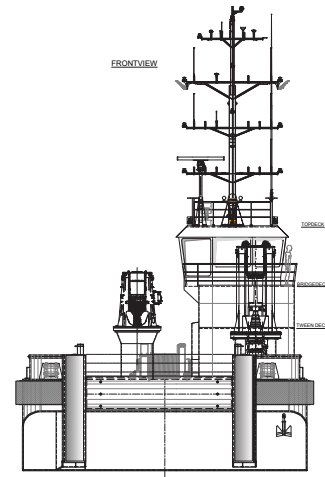
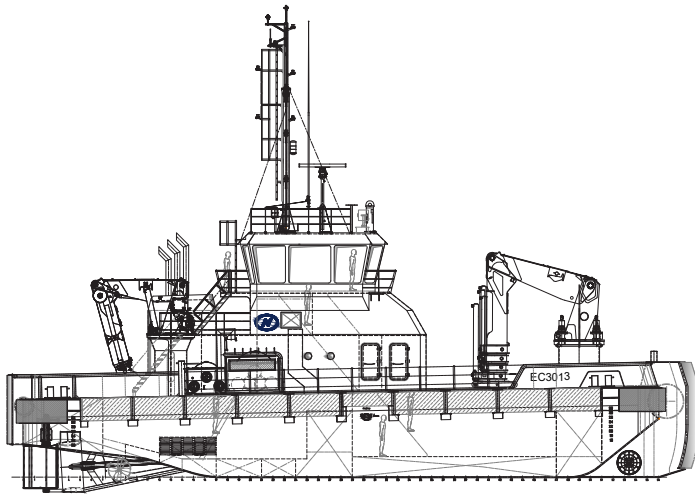

EuroCarrier 3013 | Workboat NP 640

For more information, please contact us on:
 T +31 (0)184 621 423 E info@neptunemarine.com W www.neptunemarine.com
 Version: V.02

