

**EuroCarrier 2495 | Workboat**



The robust, efficient and flexible design of the EuroCarrier makes it one of the best vessels for anchor handling, dredging support and survey activities. The EuroCarrier can be adapted to perfectly fit any project within a short time.



<b>CLASSIFICATION</b>	Bureau Veritas I  HULL • MACH		<b>TANKS</b>		
	• AUT-UMS, Unrestricted Navigation, Tug GMDSS Area A2		FUEL OIL / UREA	68 m <sup>3</sup> / 7 m <sup>3</sup>	
<b>DIMENSIONS</b>			FRESH WATER	38 m <sup>3</sup>	
LENGTH O.A.	24,00	meters	<b>DECK LAY-OUT</b>		
BREADTH MLD.	9,54	meters	ANCHOR HANDLING / TOWING WINCH	Split drum type	
DEPTH AT SIDE	2,90/3,10	meters	PULLING FORCE	70 tons at 1 <sup>st</sup> layer	
DRAFT	2,06	meters	HAULING SPEED	7m/min- 21m/min	
GROSS TONNAGE	189	tons	TUGGER WINCH	Single drum type	
NET TONNAGE	50	tons	PULLING FORCE	10 tons at 1 <sup>st</sup> layer	
<b>PERFORMANCES</b>			DECK CRANE FORWARD	Heila HLRM 170-4S	
SPEED	10 knots		DECK	Azobé deck covering	
BOLLARD PULL	23 tons		TOWING PINS	Aft ship: manual set, fore ship: hydraulic set + chain stopper	
<b>PROPULSION</b>			FENDERING	Tire fendering at sides, pushbow fendering fore- and aft ship, M-fendering at the corners	
MAIN ENGINES	2x Volvo D16 IMO TIER 3		<b>ACCOMMODATION</b>		
TOTAL POWER	1250 kW at 1800 RPM		FACILITIES	Air-conditioned accommodation for 5 crew	
PROPELLERS	1650 mm diameter in nozzle		<b>OPTIONS</b>		
BOW THRUSTER	80 kW		DECK CRANE AFT	Heila HRM 25-4S	
<b>AUXILIARIES</b>			TOWING HOOK	Mampaey 25 tons SWL	
GENERATOR SETS	1x Volvo D7A (box cooled) 1x Volvo D7A (box & radiator cooled)		CAPSTANS	5 ton, hydraulic driven	
TOTAL E-POWER	268 kW		WINCH ON FWD CRANE	5 tons	
HYDRAULIC POWER PACK	2x 75 kW		A FRAME	25 tons	

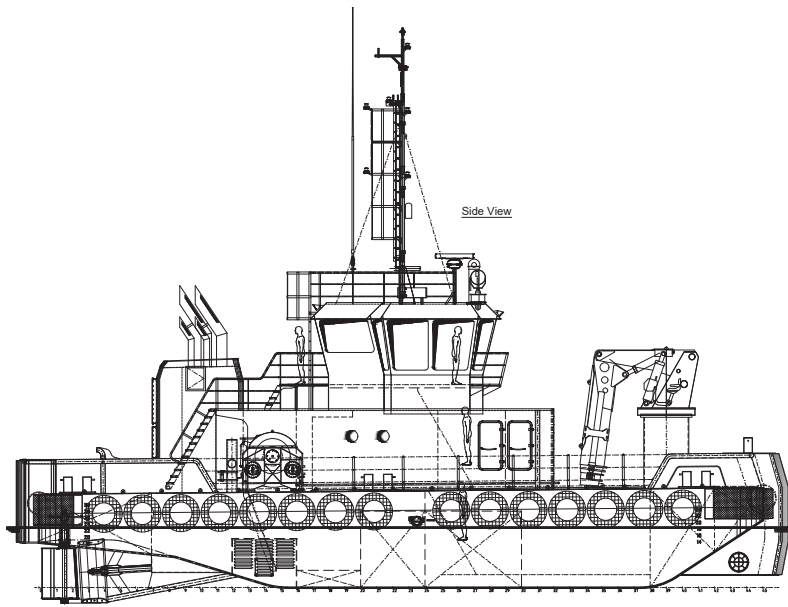

Side View

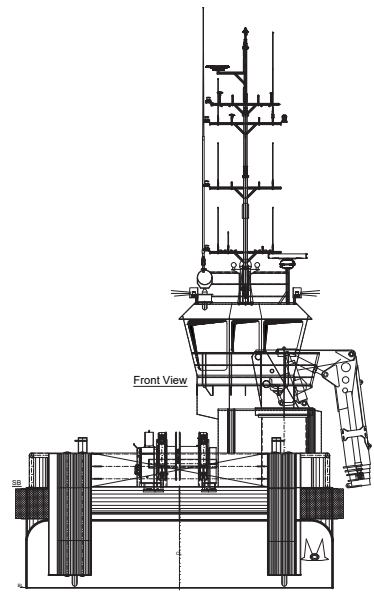

Front View

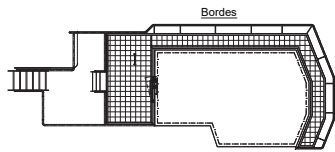

Bordes

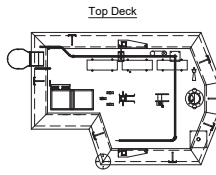

Top Deck

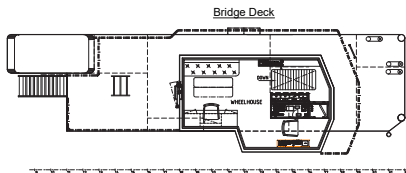

Bridge Deck

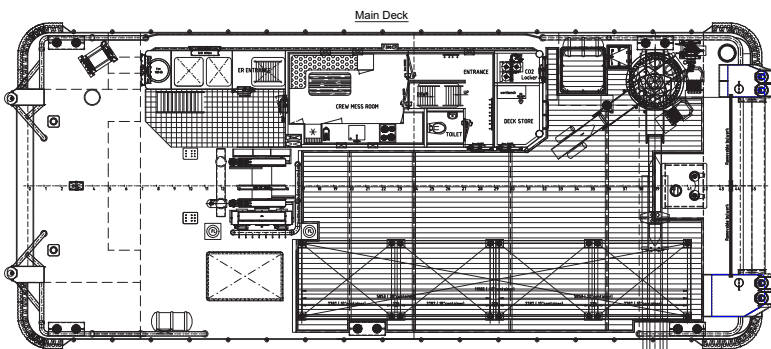

Main Deck

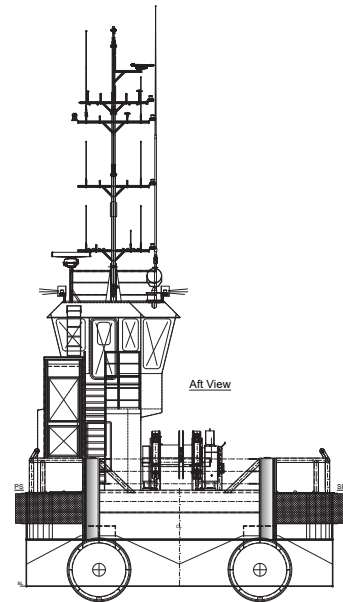

Aft View

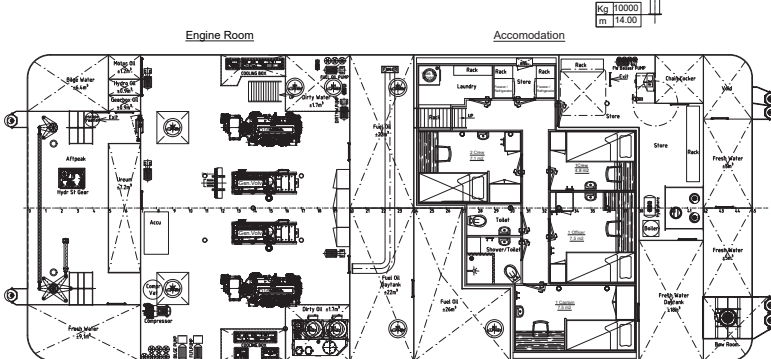

Engine Room

Accommodation

Kg 10000

m 14.00

## EuroCarrier 2495 | Workboat

For more information, please contact us on:

T +31 (0)184 621 423 E [info@neptunmarine.com](mailto:info@neptunmarine.com) W [www.neptunmarine.com](http://www.neptunmarine.com)

Version: V.01

