

Chemiflex® Composite Hose Type 416

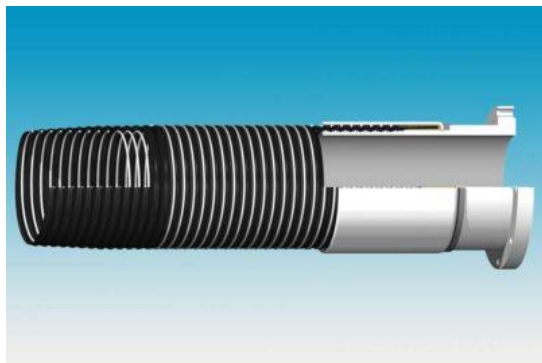

Applications

This type is recommended for use as a tank truck, railcar and in-plant multi chemical transfer applications where the economy and maximum chemical resistance of a polypropylene coated inner wire is required. A stainless steel outer wire is available for applications which include a corrosive environment.

Technical description

Lining :	Polypropylene
Inner Wire :	Polypropylene coated Steel
Outer Wire :	PGP416 Galvanized Steel PSP416 Stainless Steel 304 or 316
Cover :	PVC coated Nylon, Abrasion, UV and Ozone resistant, Black
Temperature range :	-30°C to + 80C (-22°F to + 176°F)
Electrical properties :	Electrically conductive
Standard :	EN13765:2010, Type 2
Complies with :	IMO IBC Code
Approval :	ClassNK Certificate NO. TA11773E(AL)

Physical properties

Maximum elongation :	10% on test pressure
Vacuum range :	0,9 bar

End Fittings

Specially designed end fittings have been developed for use with these Composite hoses, including threaded ends, flanged ends and other connections. By means of a hydraulic operated press, a ferrule is externally swaged onto the hose to secure the hose shank and guarantee a leak proof connection between hose and fitting. All ferrules are welded to the end fitting before swaging for even safer operating conditions.

TECHNICAL DATA: TYPE PGP426/ PSP426

Inside Diameter		Working Pressure		Min. Bend Radius		Approx Weight		Maximum Length	
Inches	mm	PSI	Bar	Inches	mm	lb/ft	kg/m	Feet	Meters
1	25	150	10	4	100	0.65	1.10	65	20
1½	40	150	10	5¼	130	0.85	1.25	65	20
2	50	150	10	6½	165	1.20	1.80	65	20
2½	65	150	10	7½	185	1.70	2.50	65	20
3	80	150	10	9½	240	2.00	3.00	65	20
4	100	150	10	14½	360	3.00	4.50	65	20

Pressure based on safety factor 5:1

All information in this document is without any obligation, dimensions and weight are approximate only and the specifications are subject to change without any notice.